

# The Christian Church (Disciples of Christ) In Florida

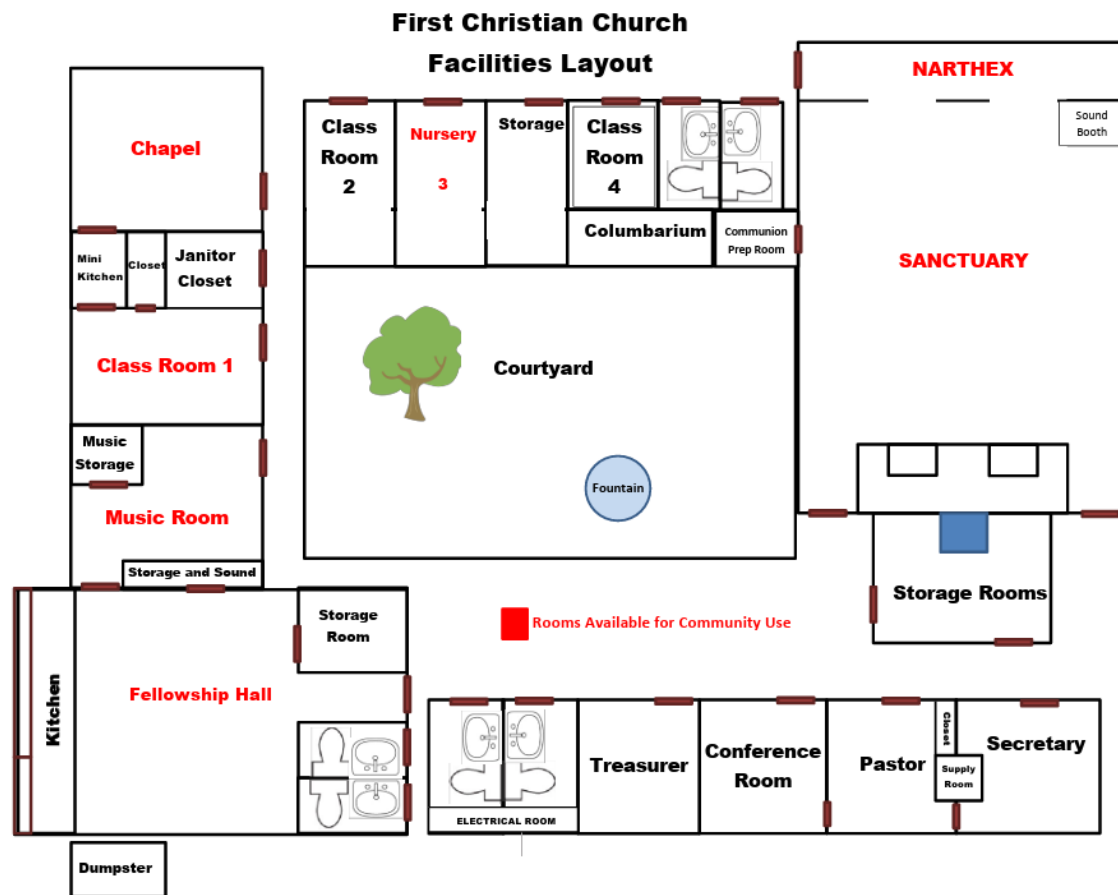

<b>MEALS:</b> Fellowship Hall	<b>EXHIBITS:</b> Corridors between buildings	<b>WORSHIP:</b> Sanctuary
<b>SATURDAY: 11:00am Round 1 Workshops</b>		<b>SATURDAY: 1:30pm Round 2 Workshops</b>
<b>MUSIC ROOM: [1B]</b> Relationship-Based Evangelism... David Miller		<b>CHAPEL: [2C]</b> Hope for the Future... Katy McFall
<b>CLASSROOM 2: [1C]</b> Cultivating Hope... Jennifer Perri/Cindy Howel		<b>CLASSROOM 1: [2D]</b> The Quiet Work... Melissa Frantz
<b>CLASSROOM 4: [1A]</b> Building Hope... Randy Johnson		<b>CLASSROOM 2: [2B]</b> Living Hope... Kimberly Weir
<b>SANCTUARY: [1D]</b> Thriving in Hope... Erin Cash		<b>MUSIC ROOM: [2A]</b> Finding Hope... Kevin Bruchert & Miranda West



TABLE OF CONTENTS

Thank You Message to First Christian Church, Haines City.....Page 1

Keynote Speaker: Dr. Denise Bell.....Page 2

Saturday: 11:00am – Round 1 Workshops.....Page 3

Saturday: 1:30pm – Round 2 Workshops.....Page 4

Worship Offering QR Codes - Friday 2:00pm Workshop – Exhibitors List....Page 5

Regional Assembly Schedule – Translation Instructions: Spanish.....Page 6

**BACK PAGE: Church Facilities Layout with Meals, Exhibits, Worship and Workshop Locations**



On behalf of the Florida Disciples Regional Church, we wish to thank First Christian Church, Haines City and Pastor Bill McConnell for your gracious hospitality in welcoming us to this Regional Assembly. In the Florida Region, we know we are a "Community of Communities, doing together what we can't do alone." We are grateful for the willingness of this congregation to host us and to provide space and volunteers to make this event a success.

Thank you also to the Regional Assembly Planning Team: Liza Miranda, chairperson, and team members: Selena Reyes, Mary Alice Mulligan, Melissa Frantz, Henri Norey, Jayne Cartegena, Lillie Espinosa, Julie Duff, Tina Christian and Sandy Messick and to all the volunteers and staff who have given of their time, talent, and energy.

With gratitude,  
Sandy Messick, Regional Minister

**FRIDAY WORSHIP OFFERING**



**SATURDAY WORSHIP OFFERING**



**FRIDAY 2:00 p.m. WORKSHOP PRESENTED BY THE PENSION FUND**

**Fund Understanding Church Retirement Benefits**

Do you know all the retirement benefits available to you and your church staff? Join Matt as he explores the retirement benefits provided by Pension Fund to clergy and church staff. We'll discuss the traditional pension plan, 403a, additional benefits available, and more. *Rev. Matt Shears, Area Director - Pension Fund of the Christian Church*

**EXIBITORS – DISPLAY TABLES**

- AllianceQ – Jonathan Adkins
- Chaplaincy and Specialized Ministries - DHM – Jonathan R. Fisher
- Christmount – Betsy Goehrig
- Disciples Church Extension Fund – Katy McFall
- Florida Disciples Comprehensive Campaign – Miranda West
- Florida Disciples Men’s Ministries – Brad Beyer
- Florida Disciples Women’s Ministry – Rachel Battaglia
- Florida Senior Enrichment Center and Silver Chalice – Kimberly Weir
- HELM – Lee Yates
- Insurance Board – Cindy Howell and Jennifer Perri
- Lambert Publishing House – Dr. Mellisa Lambert
- Lexington Theological Seminary – Erin Cash
- National Benevolent Association (NBA) – Paige Bobbitt
- Pension Fund of the Christian Church – Matt Shears
- Phillips Theological Seminary – Tara Thompson
- The Retreat at Silver Springs – Brittany Swink

## SCHEDULE

### FRIDAY – April 24

10:00am - Registration Opens

12:00pm - Clergy Luncheon: Sponsored by the Pension Fund

2:00pm - Workshop presented by the Pension Fund

4:00pm - Registration open for new arrivals

Displays open

6:00pm - Regional Assembly opens with dinner: Sponsored by the Christian Church Foundation, Randy Johnson

7:15pm - Pre-worship celebration: A celebration of Regional Ministries

7:30pm - Opening Worship

**Keynote Speaker: Dr. Denise Bell**

8:50pm - After Session

**After Session - Phillips Alum Gathering:** Alums are invited to Beef O'Brady's after worship on Friday evening to visit and socialize. Info for Beef O'Brady's: 902 Old Polk City Rd, Haines City, FL 33844

### SATURDAY – April 25

Note: Breakfast on your own.

8:00am - Displays open

Registration open

9:00am - Morning Devotions

9:30am - State of the Region: Rev. Sandy Messick

10:00am - Comprehensive Campaign Launch

10:45am – 15 min. Break

11:00am - Morning Workshops

12:00am – Lunch: Sponsored by Disciples of Church Extension Fund

1:30pm - Afternoon Workshops

2:30pm - Pre-worship celebration: A celebration of Regional Ministries

2:45pm - Closing Worship with communion

**Keynote Speaker: Rev. Dr. Denise Bell** – Sermon Title: Hope never dies!

Bible Text: Luke 24:13-35

### TRANSLATION: SPANISH

**Spanish:** Telefono: 1-206-279-9585 andCodigo: 128400

**Keynote Speaker: Dr. Denise Bell, Donald and Lillian Nunnely Chair and Assistant Professor of Pastoral at Lexington Theological Seminary**



Dr. Bell is the at LTS. She served as the Regional Minister of the Christian Church (Disciples of Christ) in Georgia from 2014-2023. For 35 years, she served churches as pastor, associate, senior associate, satellite pastor, interim pastor, and executive pastor. As a church leader, her enthusiasm in ministry comes from her excitement in seeing lives and churches transformed by fresh ideas and boldness. She engages with others in seeking God for a way that bridges traditional and contemporary paths to meet today's changes and opportunities.

Dr. Bell served as the Regional Minister of the Christian Church (Disciples of Christ) in Georgia from 2014-2023. For 35 years, she served churches as pastor, associate, senior associate, satellite pastor, interim pastor, and executive pastor. As a church leader, her enthusiasm in ministry comes from her excitement in seeing lives and churches transformed by fresh ideas and boldness. She engages with others in seeking God for a way that bridges traditional and contemporary paths to meet today's changes and opportunities. Her ministry is grounded in loving and serving the world with others who practice the principles of faith. Dr. Bell earned her MDiv from Denver Theological Seminary and received her Ph.D. in Organizational Leadership from Eastern University in St. David's, Pa., where she studied the practices of flourishing African American pastors and challenged research regarding clergy wellbeing. She received the 2022 Dissertation of the Year Award. As an educator and minister of practice, Dr. Bell seeks to help pastors and congregations increase their capacity to flourish and to be healthy communities of faith in a changing world. She serves the body of Christ as preacher, retreat speaker, teacher, leader, counselor, and coach. Topics for which Pastor Bell provides insight includes leadership development, personal leadership, team building, mission and vision casting and church transformation. Her ministry is weaved together by her faith in a faithful God. She is God's daughter, God's servant, and a messenger for Christ. She loves the Lord and has a love for God's people as God has called her to be Christ incarnate to a world that needs to know that God loves and calls all according to God's purposes.

## SATURDAY: 11:00am Round 1 Workshops

**[1A] Building Hope Through Establishing and Growing Legacy Fund Giving in Your Congregation– Randy Johnson (CCF):** Healthy churches need to develop multiple streams of income. In this workshop, you will learn how to invite, encourage and mentor church members to join you in offering generous end-of-life gifts to support the ministries you all love. You will learn how so many other congregations are doing this successfully and how non-threatening, fun and rewarding the process will be!

**[1B] Relationship Based Evangelism: Walking not Winning – David Miller, Beneva Christian Church:** How overwhelming is it to think about going into all the world and making disciples? Well, Jesus gave this Great Commission to eleven disciples and look what happened! Did each of the disciples go into all the world? No. But each disciple did go into their world. Now you're invited to do the exact same thing.

**[1C] Cultivating Hope Through Safe Ministry Practices - Jennifer Perri/Cindy Howell (Insurance Board):** This workshop explores how strong policies and safe procedures create a foundation of hope for congregations. Participants will receive practical guidance for reducing risk, strengthening accountability, and protecting the people and ministries they serve. Thoughtful safety practices not only prevent harm but also foster trust, stability, and a hopeful future for the whole church community.

**[1D] Thriving in Hope: What Thriving Can Look Like in These Times - Erin Cash (LTS)**  
Drawing on research from the Thriving Congregations Project at Lexington Theological Seminary, Rev. Dr. Erin Cash will offer practical insights, real stories, and usable tools to help congregations clarify their calling to live with hope during tumultuous times. This workshop aims to leave you with hope that your church can thrive in your context. Whether you are on the cusp of thriving or already flourishing, come learn about how to increase your hope by living as a thriving church.

## SATURDAY: 1:30pm Round 2 Workshops

**[2A] Finding Hope in Resurrection - Meizon's story of how God is making all things new!–Kevin Bruchert & Miranda West, Meizon Church:** Meizon Church is a new church in the region. The story of their merge with First Christian Church of Gainesville is just one story of how we can honor the legacy of what was while also embracing new and innovative practices to create a hopeful future.

**[2B] Living Hope as a Silver Chalice Congregation – Kimberly Weir:** This is an introduction to Silver Chalice that includes the purpose and goals, the Resolution that was passed at GA, what has happened since GA, and how the Silver Chalice ministry lives into the hope, witness, and legacy of our seniors.

**[2C] Hope for the Future: Strategic Ministry Planning with DCEF – Katy McFall (DCEF):** This workshop offers practical guidance for congregations seeking to plan faithfully and strategically for the future. Katy McFall will introduce accessible tools for assessing ministry needs, setting clear priorities, and aligning resources with mission. Participants will gain a hopeful, realistic framework for shaping ministries that are sustainable, responsive, and grounded in the life of their congregation.

**[2D] The Quiet Work of Hope - Melissa Frantz:** A gentle 50 minute gathering to rest, reconnect, and remember the hope that awakens within us, unites us with one another, and moves with us back into our ministries. Through reflection, conversation, and simple practices, we'll make space for the kind of hope that steadies the soul and strengthens community.